

SARGENT AND GREENLEAF®

A Subsidiary of Stanley Security Solutions, Inc.

Z⁰³ Rotarybolt® Solenoid Activated Safe Lock



Z⁰³ LOCK BODY



LOW PROFILE KEYPAD

- Underwriters Laboratories Listed Type 1, CEN B, VdS Class 2, A2P B/E, DNV 3492, and RoHS compliant.
- The Z⁰³ is shipped from S&G in multiple user mode, but can be easily converted to dual user mode in the field¹ by simply entering a keypad command (instructions furnished with the lock):
 - Multiple user—Any of the lock's codes can be used to open. Multiple user can also be used in a Manager/Employee mode, in which the master and supervisor codes toggle the lock on and off for operation by the holders of user codes.
 - Dual user—The lock can only be opened if two separate codes are entered within one minute of each other. This provides a higher level of access control.
- The Z⁰³ Rotarybolt® lock features a counterbalanced solenoid locking mechanism for a high level of security and extended battery life.
- The multiple user mode provides for a management reset code. The dual user mode does not provide for a management reset code.
- One master code, one supervisor code, seven user codes, and one time delay override code.*
- Penalty time feature to prevent opening by entering sequential or random codes until a valid code is found.
- Time delay up to 99 minutes, and provide for one time delay override code for cash carrier applications.
- Duress capability allows a distress signal to be sent through the customer's central alarm system in the event of an emergency. An optional duress module (part #6102-090) is required to use this function.
- An optional, easy-to-add bolt position indicator is available that closes a circuit when the lock bolt is in either the locked or unlocked position (see description below).
- Can be used with the 2-battery keypad and the low profile keypad.
- Handed construction allows you to match the specific Z⁰³ model to your safe's boltwork design.

* If a multiple user lock has the duress feature enabled, User PINs 4 through 8 are automatically disabled and are not available. A dual user lock always has all codes available for use. In both models, the Time Delay Override Code uses PIN 9. If Time Delay Override is disabled, PIN 9 works like a standard User code.

¹ Change is irreversible.

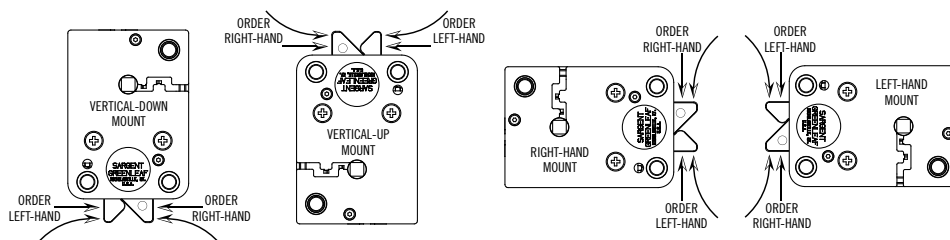

Lock Bodies (only) and Lock Bodies with Keypads

Lock Construction	Lock Body Only	6130-400 Keypad
left-hand	2003-300	2003-304
right-hand	2003-200	2003-206

Add a bolt position indicator module to any Z⁰³ Rotarybolt® lock in a minute or less.



Keypads (only)

Non-Rotating Low Profile Keypad	Bezel Finish
6130-400	buffed chrome

